

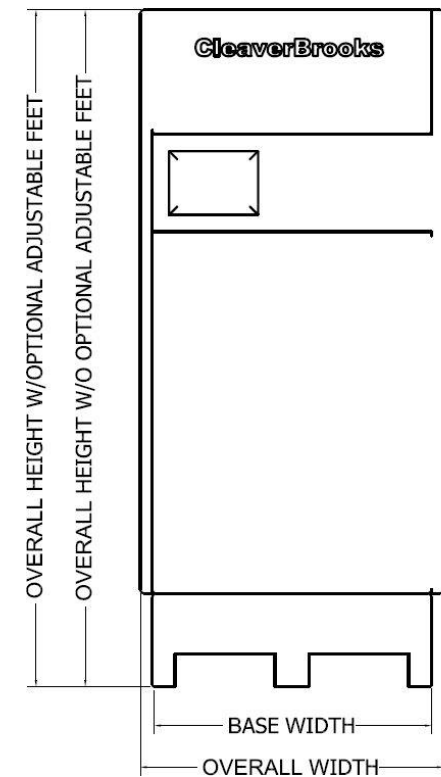

**Dimensions & Ratings**  
 Models: CFC-E-700-(500 to 6000)-125HW  
 Date Revised: April 28, 2020

APPLICATION DATA – Model: ClearFire® CE | Fuel Series: 700 | Design Pressure: 125 psi Hot Water | System Voltage: 115/1/60 | NOx Emissions Level: ≤20ppm | Elevation: 700 ft ASL

Input Capacity (MBtu/hr):	500	750	1000	1500	2000	2500	3000	3500	4000	5000	6000
<b>Dimensions [in.]</b>											
Overall Height w/o Optional Adjustable Feet:	78	78	78	80	80	95.2	95.2	91.25	91.25	93.75	93.75
Overall Width:	35	35	35	36	36	35.7	35.7	48.5	48.5	58.75	58.75
Overall Length:	50	50	50	56	56	56	56	68.5	68.5	80.75	80.75
Base Width:	32.25	32.25	32.25	33	33	33	33	45.75	45.75	56	56
Base Length:	50	50	50	56	56	56	56	68.5	68.5	80.75	80.75
<b>Ratings</b>											
Output Capacity at 100% Firing Rate (120/80°F) [Btu/hr]:	470,000	705,000	940,000	1,410,000	1,880,000	2,350,000	2,820,000	3,290,000	3,760,000	4,700,000	5,640,000
Output Capacity at 100% Firing Rate (180/140°F) [Btu/hr]:	440,000	660,000	880,000	1,320,000	1,760,000	2,200,000	2,640,000	3,080,000	3,520,000	4,400,000	5,280,000
Maximum Allowable Working Pressure (MAWP) [psig]:	125	125	125	125	125	125	125	125	125	125	125
Maximum Allowable Working Temperature (MAWT) [°F]:	210	210	210	210	210	210	210	210	210	210	210
Electronically Commutated Blower Motor [W]:	335	335	335	1,700	1,700	1,200	2,400	2,400	2,400	8,000	8,000
Condensate Production firing Natural Gas (120/80°F) [gal/hr]:	3.5	5	6.5	10	13.5	17.6	20.6	24	27	34	40.5
Flue Gas Mass Flow at 100% Firing (Natural Gas) [lb/hr]:	557	835	1,113	1,670	2,226	2,863	3,340	3,897	4,452	5,567	6,678
<b>Fuel Consumption Ratings (Approx.)</b>											
Natural Gas (1 MBtu) [cfh]:	500	750	1,000	1,500	2,000	2,500	3,000	3,500	4,000	5,000	6,000
Propane Gas (2.5 MBtu) [cfh]:	200	300	400	600	800	1000	1200	1,400	1,600	2,000	2,400
<b>Weights [lb]</b>											
Shipping Weight (Approx.):	1,413	1,413	1,511	1,986	2,166	2,541	2,596	3,726	3,913	5,073	5,450
Operating Weight:	2,065	2,065	2,113	2,778	2,858	3,470	3,492	5,227	5,304	7,502	7,659

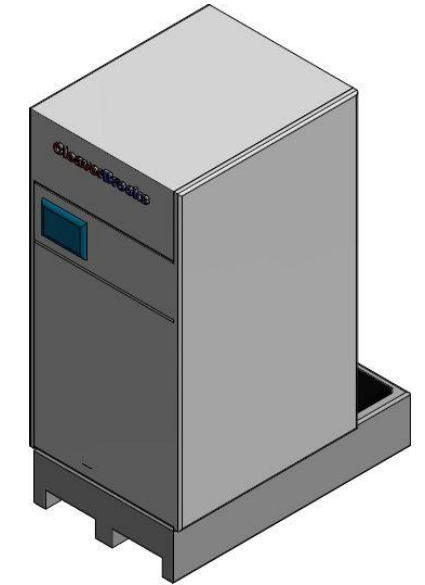

**FRONT VIEW**

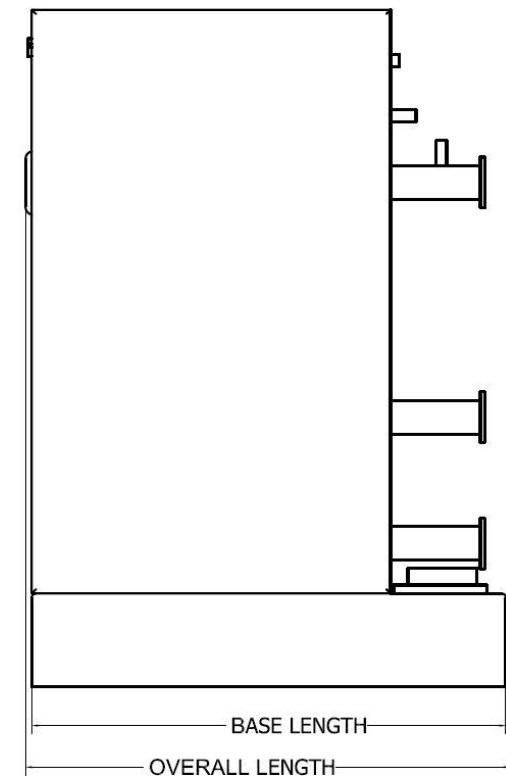

**RIGHT SIDE VIEW**

**NOTE: All dimensions are approximate. Product data may vary based on application. Contact your local Cleaver-Brooks representative for additional information.**