



## Clearances

Models: FLX-200-(1250 to 2500)-150ST  
Date Revised: September 21, 2017

APPLICATION DATA – Model: FLX | Fuel Series: 200 | Design Pressure: 150 psi Steam | Operating Pressure: 125 psi | System Voltage: 460/3/60 | NOx Emissions Level: 30ppm | Feedwater Temperature: 212°F | Elevation: 700 ft ASL

Input Capacity [10 MBtu/hr]:	DIM	1250	1450	1650	1850	2100	2500
<b>Clearances [in.]</b>							
Boiler:	MAGENTA	18	18	18	18	18	18
Electrical Panel (460V):	GREEN*	42	42	42	42	42	42
Tube Removal:	ORANGE	40	40	47	47	62	62
Service Area (Rear):	ORANGE	24	24	24	24	24	24
Service Area (Front):	ORANGE	36	36	36	36	36	36
Front Door Swing:	BLUE		36				

[GREEN\*] NOTE: Electrical panel location determined by application.

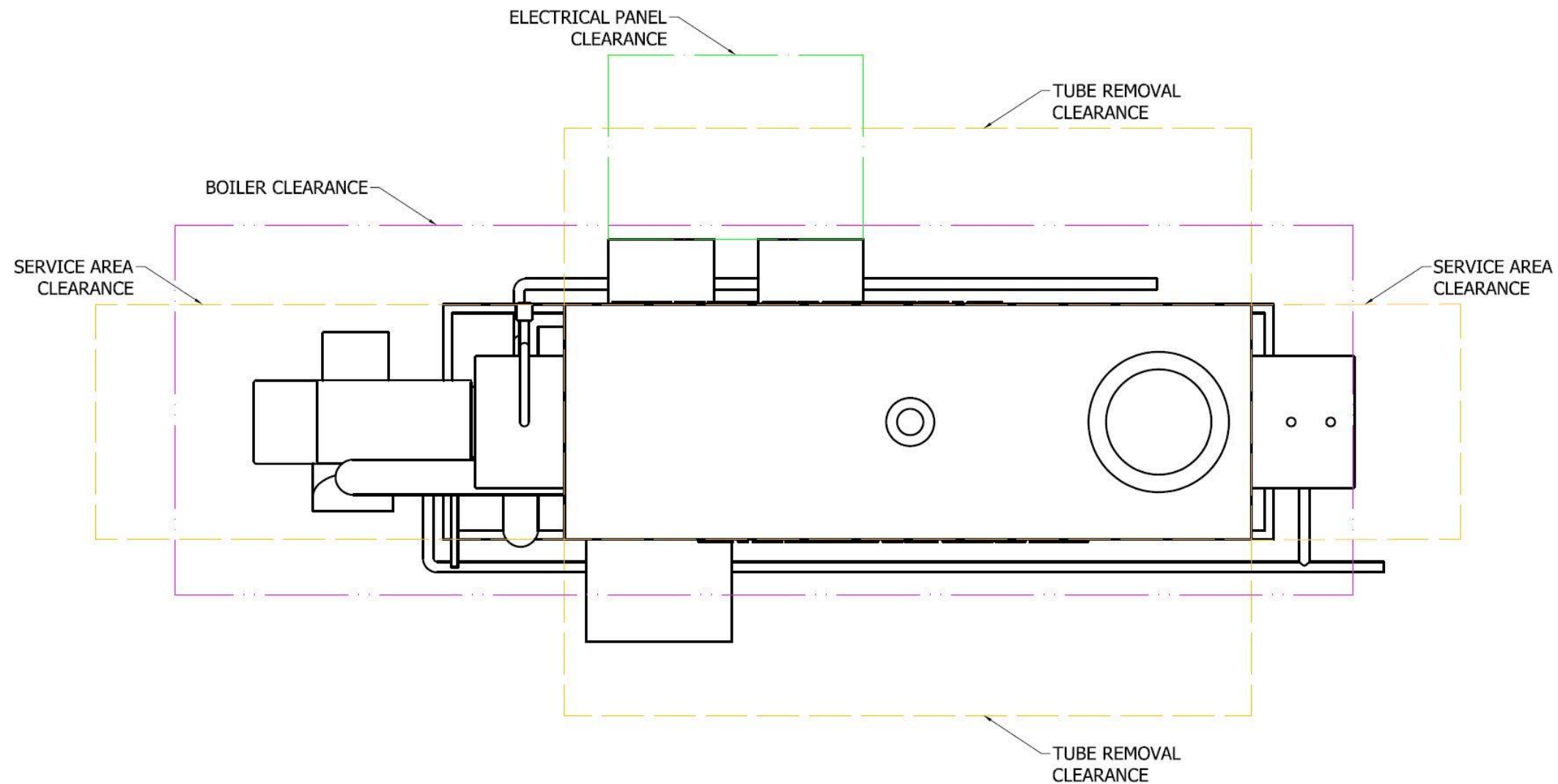
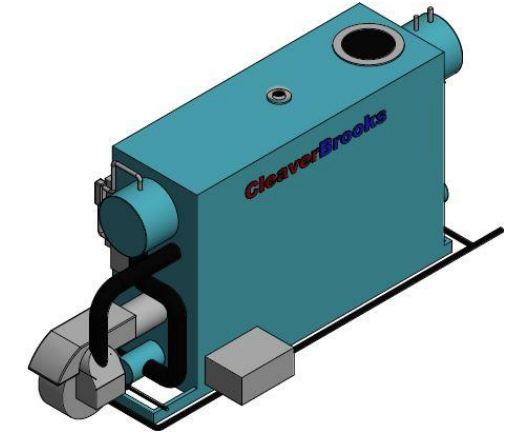

TOP VIEW

**NOTE: All dimensions are approximate. Product data may vary based on application. Contact your local Cleaver-Brooks representative for additional information.**